



Garden Ponds Unlimited LLC[®]

405-799-POND (7663)

310 SW 1st St Moore, OK 73160 (I-35 & 4th St.)

Visit us online at www.gardenpondsunlimited.com



Imagine...

Water gardens transform an outdoor living space into a beautiful paradise where you can relax, unwind, and enjoy quality time with family and friends. Water features become the focal point of any garden with their melodious tunes and natural ability to attract a variety of birds and butterflies. Whether you tuck a decorative fountain near the entrance of your home or create a backyard habitat with an Koi pond and waterfall, you'll find each day enhanced when you waterscape your landscape. Whether you have an expansive lawn or a small courtyard, you'll find a water feature to suit your lifestyle and budget.

Close your eyes and imagine your ideal vacation spot. Is it on the water? Why? Because our bodies are comprised mainly of water, we are naturally drawn to it. It's this connection that Garden Ponds Unlimited understands and this relationship that drives us to provide our clients with one of a kind water features that create a paradise vacations at home.

You Deserve It!

Don't you deserve your own piece of paradise to come home to each day? Take the plunge and join the thousands of "pondaholics" in Oklahoma who are already enjoying the hottest trend in landscaping today!

Why Garden Ponds Unlimited® ?

Garden Ponds Unlimited plays an integral role in the state to enhance the environment and beautify landscapes across Oklahoma. We are considered to be the top innovators in Oklahoma for the water garden industry. We have been in business since 1997. We build more quality water features each year than any other company in the entire state of Oklahoma, with more than 1500 ponds built in the OKC metro area. We are the only pond builder in the state to have a fully stocked retail pond store with display ponds onsite and every product necessary to keep your water feature operating at its fullest potential. We are open six days a week all year long. When you choose us, you'll never have to worry about service after sale. In addition to our pond installation crew and retail store, we have dedicated technicians to service your pond needs and repairs promptly. We are able to do this because building water features is our full-time focus. Not just something we do on the side. Because of this we are able to offer the only clear water guarantee in the state.

Our mission is to enrich the lives of our customers by providing them with the water garden lifestyle and superior customer service and service after the sale.

"Ponds Done Right the First Time"™



Let the hands of our artists transform your backyard!

The Benefits of Water Features

Home Improvement & Curb Appeal

Enhanced landscaping improves property value, and water features make your property stand out from the rest. A Pondless Waterfall in the front yard provides curb appeal, while a backyard Koi Pond increases a home's value much like a deck, patio, or gazebo. The sound of a water feature will drown out noise from traffic or neighbors.



Quality Family Time

Backyard ponds create a gathering spot for family and friends. Enjoy family meals outside near the pond and spend the evening unwinding with your loved ones. Educate young children on the wonders of nature with an ecosystem pond.

Health and Wellness

Water features provide soothing sights and sounds that help you relax and de-stress in today's busy world. Lower your blood pressure and improve your physical and mental health as you prop your feet up and enjoy the therapeutic effects of Mother Nature. Get outside and soak up the sun.



A Low Maintenance New Hobby

An ecosystem pond is self-sustaining with very little maintenance. It requires less water than the area of lawn it replaced. A pond provides opportunity to have fish as pets, without the mess and maintenance of an aquarium. Aquatic plants give you the chance to broaden your gardening horizons with choices that go beyond the standard petunia and rose. In addition, bird lovers will delight in the new variety of feathered friends that flock to a water feature. Nature lovers simply can't go wrong with water features.

No More Bare Spots In Your Yard

Replace that ugly patch of dirt in your yard where you just can't get grass to grow. Waterfalls or a Koi pond is the perfect alternative. We remove the eyesore and add beauty. The perfect solution.

Reduce Traffic Noise

Do you live near a busy street or highway? Waterfalls dramatically help reduce traffic noise. We can add echo chambers built into the waterfalls that amplify their sound.





Small Water Features

A **Small Water Feature** adds a splash of water to your yard.

Perfect for smaller spaces, and available in a variety of styles, you're sure to find one that suits your taste and budget. Butterflies and birds will enjoy the refreshment your water feature brings to the garden. You'll delight in the sights and sounds of nature that a small decorative water feature provides. We can also add any of our small water features to larger ponds as an accessory.

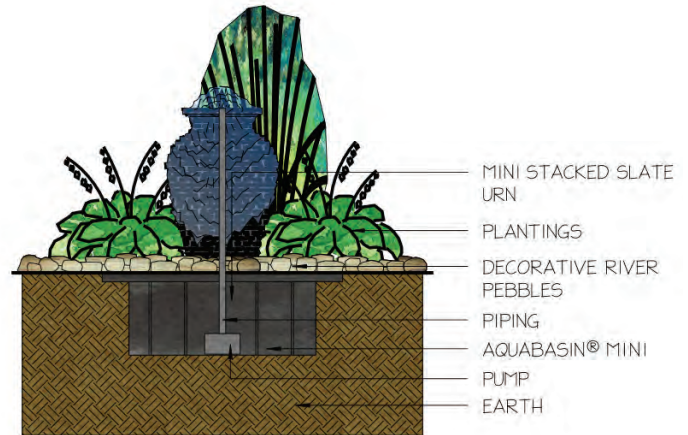



Stacked Slate Spillway Wall



Medium Stacked Slate Sphere

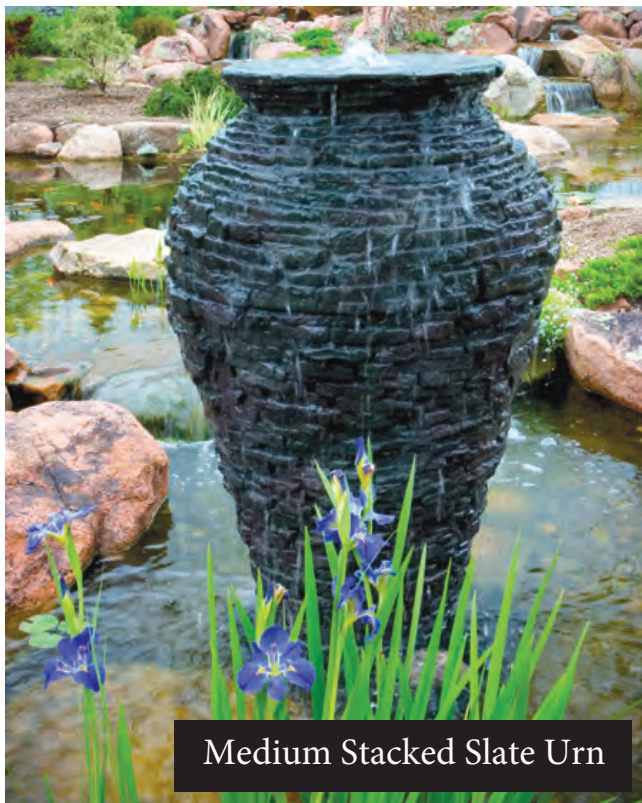

Medium Stacked Slate Urn

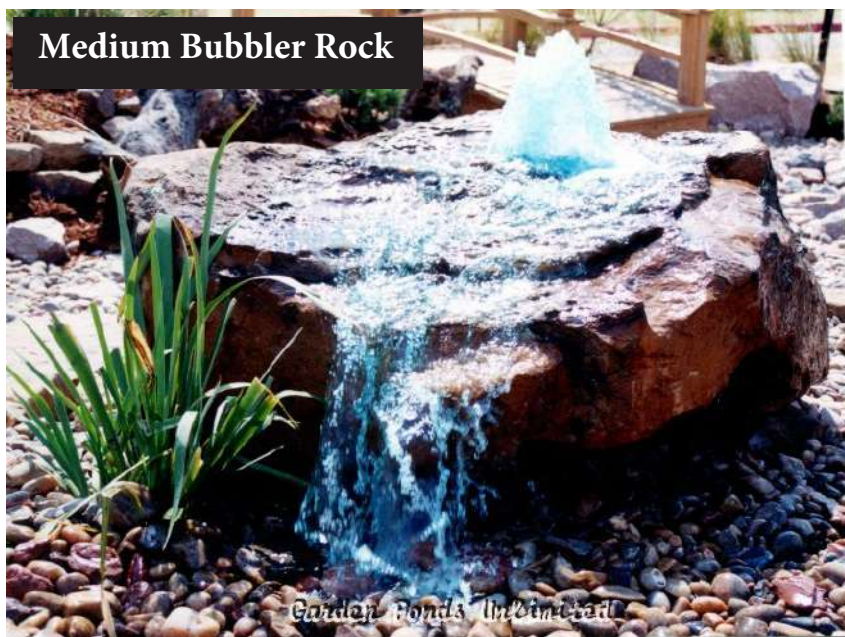

Medium Bubbler Rock



All Decorative Water Features include:

Fountain • Water Reservoir • Energy Efficient Pump • Pipe and Fittings • Mixed River Stone • Design and Installation

**ENHANCE YOUR DECORATIVE WATER FEATURE
WITH THESE EXTRAS:**

LED Lights - Do you envision sitting outside during the morning or evening hours enjoying your water feature? LED water feature lights will extend the viewing times for your water feature. Using a remote, color lights provide an impressive range of color options including white.

Color Changing Light Kit 3 Lights -

Decorative Light Kits include:

- *3 LED color changing lights*
- *Low voltage transformer*
- *Low voltage cable*

Faux Oak Stump Cover – A great way to hide electrical outlets.

Auto-Fill System - Automatically detects low water levels and fills your feature with water

Fire Fountain Add On - Add the element of fire to your water feature









Pondless Waterfalls

The waterfall is, without a doubt, the most beautiful and sought after landscape water feature.

If you are looking to enjoy the soothing sights and sounds of running water, consider a **Pondless Waterfall**.

What is a Pondless waterfall? It's a recirculating waterfall that falls into a gravel reservoir. Basically a waterfall without the pond. Pondless.

Each Pondless Waterfall is custom designed and built to ensure we exceed your expectations. Children & pets will love exploring the nature that surrounds a Pondless Waterfall, with birds and wildlife becoming frequent visitors.

Introducing the low maintenance **Pondless Waterfalls**.

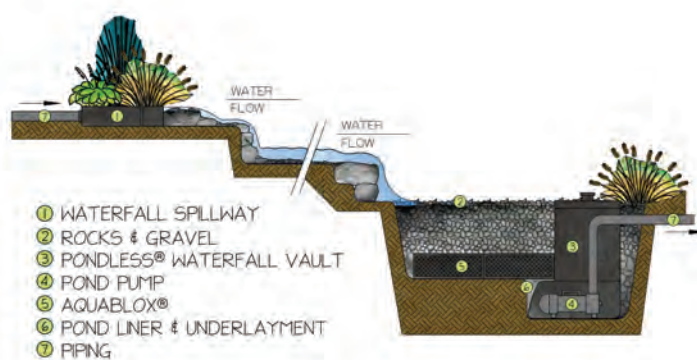
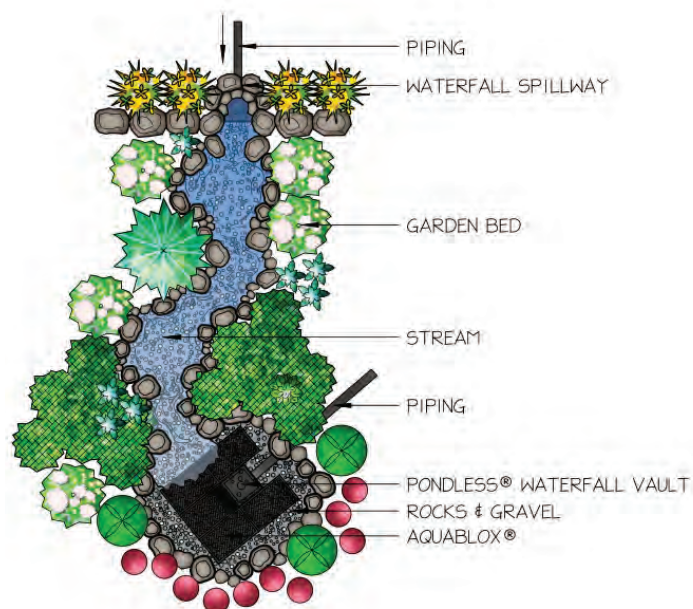

Pondless Waterfalls

"We love the Pondless Waterfall at our front door. It is a big wow factor for all those that approach our home."

Ken, Edmond, OK



6' ft Pondless Waterfall

Are you looking for the sounds of a waterfall but have a very small space? This compact 1' high waterfall with a 6' stream will fit into small spaces providing soothing sights and sounds.

6' Pondless Waterfall includes:

Stream Liner • Water Reservoir • Waterfall Spillway • Energy Efficient Pump
Rock Boulders (Standard up to 150 lbs) (Premium Artisan up to 2000 lbs) • River Stone • Design and Installation

ENHANCEMENTS AVAILABLE WITH YOUR PONDLESS WATERFALL:

Lights - Envision sitting outside during the morning or evening hours enjoying your water feature. LED water feature lights will extend the viewing times for your feature.

Pondless Waterfall Light Kit includes:

- 3 LED color changing lights
- Low voltage transformer
- Low voltage cable

Faux Oak Stump Cover - A great way to hide electrical outlets

Auto-Fill System - Automatically detects low water levels and fills your feature with water.

Water plants - A selection of aquatic plants will provide color and texture to your water feature.

Echo Chamber - Intensify the sound.



Visit us online at www.gardenpondsunlimited.com

310 SW 1st St Moore, OK 73160 (I-35 & 4th St)

405-799-POND (7663)



10' ft Pondless Waterfall

Do you enjoy sitting outside after a long day at work? Would the sights and sounds of a beautiful 2' high cascading waterfall, meandering along a 10' stream ease the stresses of your day?

Medium Pondless Waterfall includes:

Basin and Stream Liners • Pondless Waterfall Vault • Waterfall Spillway • Energy Efficient Pump Aquablox Water Storage Modules • Rock Boulders (Standard up to 150 lbs) (Premium Artisan up to 2000 lbs) • River Stone • Design and Installation

ENHANCEMENTS AVAILABLE WITH YOUR PONDLESS WATERFALL:

Lights - Envision sitting outside during the morning or evening hours enjoying your water feature. LED water feature lights will extend the viewing times for your feature.

Pondless Waterfall Light Kit includes:

- 3 color changing lights
- Low voltage transformer
- Low voltage cable

Faux Oak Stump Cover - A great way to hide electrical outlets.

Auto-Fill System - Automatically detects low water levels and fills your feature with water.

Water plants - A selection of aquatic plants will provide color and texture to your water feature.

Echo Chamber - Intensify the sound.

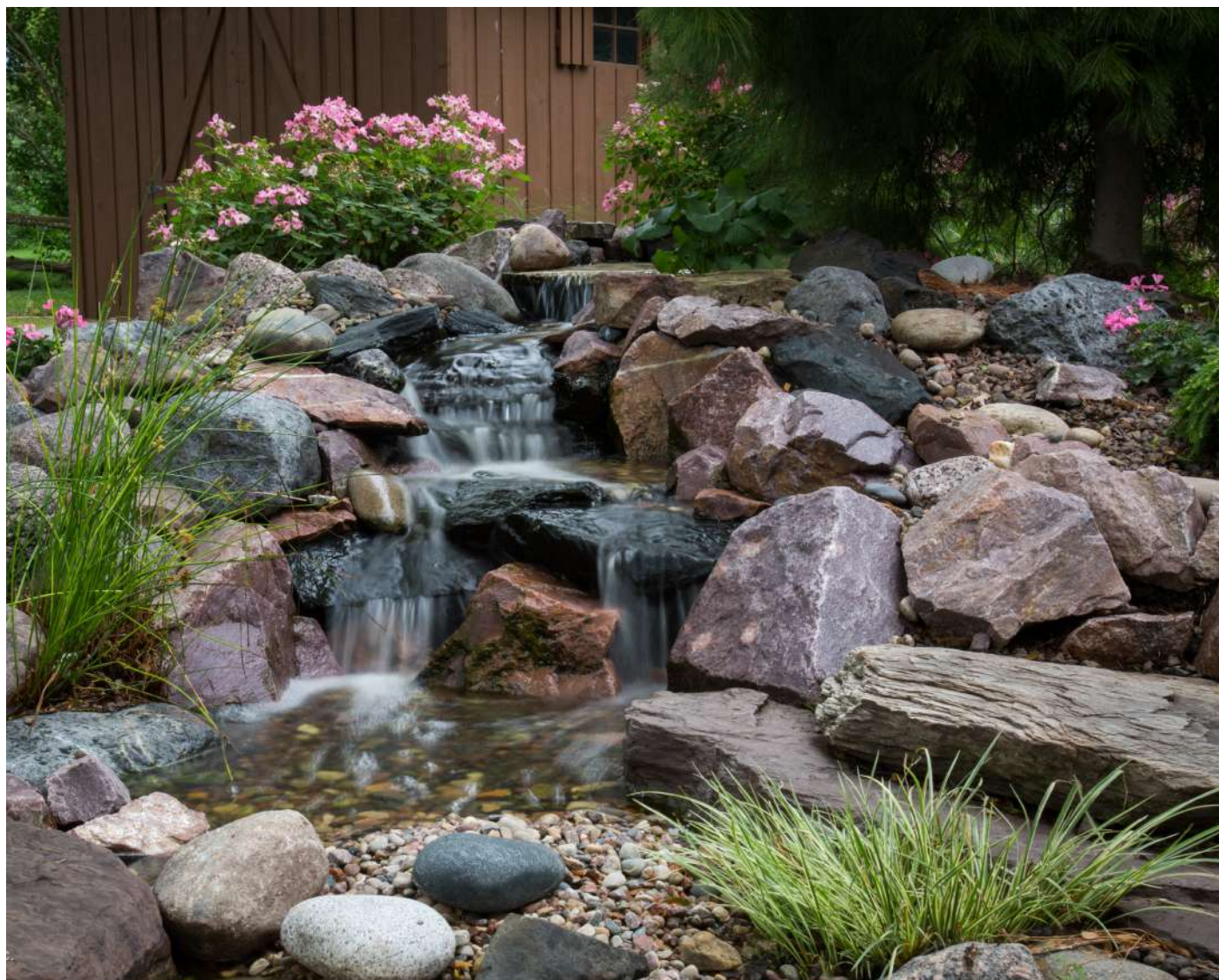

15' ft Pondless Waterfall

Do you often entertain guests and believe that a water feature would be the perfect centerpiece to your landscape? Impress your guests with our most popular waterfall, complete with a cascading 2'.5 high waterfall and 15' meandering stream.

Large Pondless Waterfall Includes:

Basin and Stream Liners * Pondless Waterfall Vault * Waterfall Spillway * Energy Efficient Pump
 * Aquablox Water Storage Modules * Rock Boulders (Standard up to 150 lbs) (Premium Artisan up to 2000 lbs) * River Stone * Design and Installation

ENHANCEMENTS AVAILABLE WITH YOUR PONDLESS WATERFALL:

Lights - Envision sitting outside during the morning or evening hours enjoying your water feature. LED water feature lights will extend the viewing times for your feature.

Pondless Waterfall Light Kit includes:

- 6 LED color changing lights
- Low voltage cable
- Low voltage transformer

Faux Oak Stump Cover – A great way to hide electrical outlets \$185
Auto-Fill System - Automatically detects low water levels and fills your feature with water.

Water plants - A selection of aquatic plants will provide color and texture to your water feature.

Bridge - Add interactive appeal with a bridge.
Echo Chamber -Intensify the sound.



20' ft Pondless Waterfall

Do you have a larger space or hill that you have always envisioned water flowing over? Imagine a pondless waterfall, complete with a 3' high waterfall cascading down a 20' stream.

Extra Large Pondless Waterfall includes:

Basin and Stream Liners • Pondless Waterfall Vault • Waterfall Spillway • Energy Efficient Pump
Aquablox Water Storage Modules • Rock Boulders (Standard up to 150 lbs) (Premium Artisan up to 2000 lbs) • River Stone • Design and Installation

ENHANCEMENTS AVAILABLE WITH YOUR PONDLESS WATERFALL:

Lights - Envision sitting outside during the morning or evening hours enjoying your water feature. LED water feature lights will extend the viewing times for your feature.

Pondless Waterfall Light Kit includes:

- 10 LED color changing lights
- Low voltage cable
- Low voltage transformer

Faux Oak Stump Cover – A great way to hide electrical outlets.

Auto-Fill System - Automatically detects low water levels and fills your feature with water.

Water plants - A selection of aquatic plants will provide color and texture to your water feature.

Bridge - Add interactive appeal with a bridge.

Echo Chamber - Intensify the sound.



Garden Ponds Unlimited

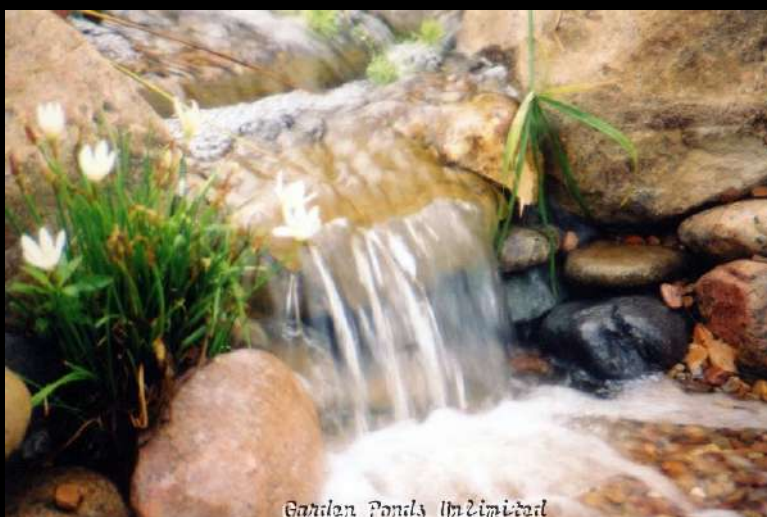

Garden Ponds Unlimited

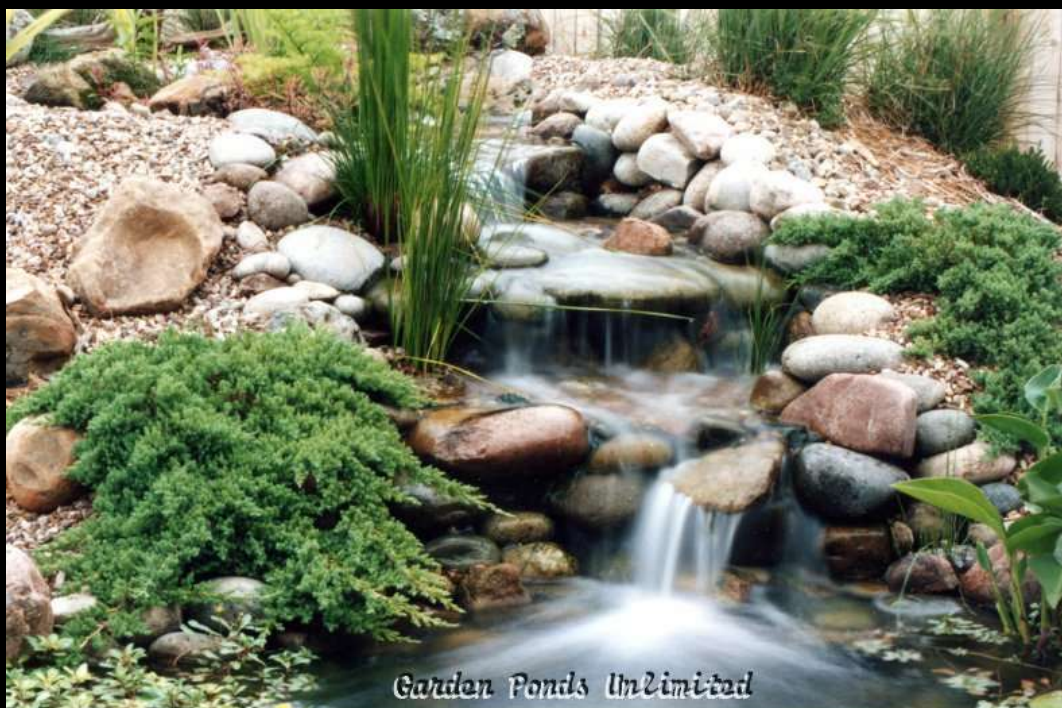

Garden Ponds Unlimited



*Create an interactive experience
with your pond by adding Koi.*



Custom Koi Ponds



Imagine coming home after a long day and stepping outside
to your own backyard oasis.

Picture yourself relaxing with a glass of
wine as you listen to the soothing sounds
of a **waterfall and stream.**

Imagine feeding fish out of your hand as the cares of the world slip away.

The stresses of the day will melt away. Soon this will be your favorite room in the house.

The possibilities are endless!

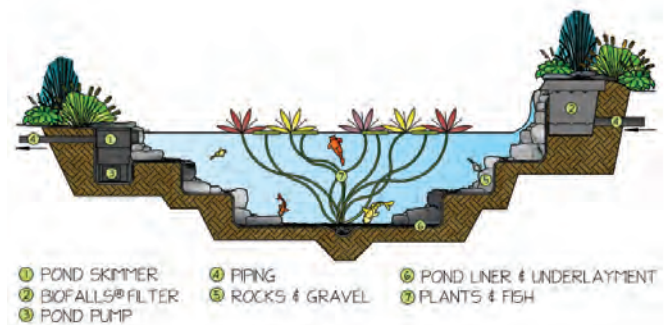
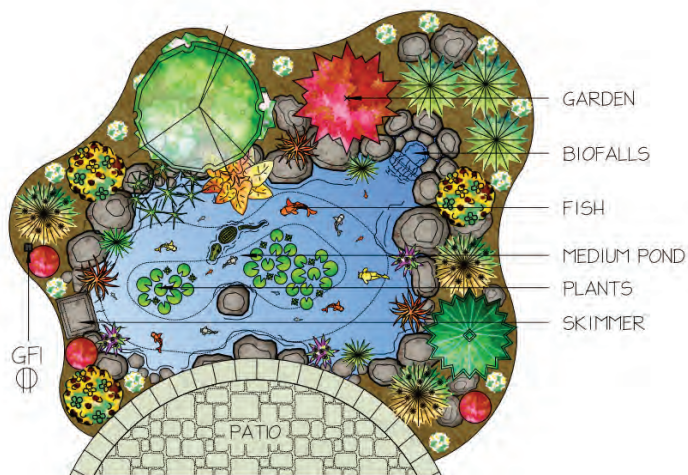

*“I used to come home after work and turn on the
television. Now I rush outside to relax by my pond and
waterfall. The pond has changed my life.”*

John Norman, OK



Small Custom Koi Ponds

Do you dream of having a pond but aren't sure if you're ready to take the plunge? Then the small pond is perfect for those looking to get their feet wet in the hobby.

Standard 4'X6'X2'

Standard 6'X8'X2'

Standard 8'X10'X2' (This size on display at our store)

Small Ponds with Waterfall includes:

Pond and Waterfall Liners • Skimmer • Biological Filter • Energy Efficient Pump
• Rock Boulders up to 150 lbs • River Stone • Design and Installation

ENHANCEMENTS Available WITH YOUR SMALL POND WITH WATERFALL:

Lights - Envision sitting outside during the morning or evening hours enjoying your water feature. LED water feature lights will extend the viewing times for your feature.

Pond with Waterfall Light Kit includes:

- 3 LED color changing lights
- Low voltage transformer
- Low voltage cable

Faux Stump Cover - A great way to hide electrical outlets.

Auto-Fill System - Automatically detects low water levels and fills your feature with water.

Water plants - A selection of aquatic plants will provide color and texture to your water feature.

Koi Tunnel - The perfect place for your fish to hide.

Echo Chamber - Intensify the sound of a waterfall.



10'X14'X2' Custom Koi Pond with Waterfalls

Custom Koi Ponds

Do you imagine coming home after a long day to a glass of wine as you listen to the soothing sound of your waterfall? Imagine the sights and sounds of a 2' high waterfall cascading down a 5' stream into your 10' x 14' x 2' deep pond.

This size pond on display at our store

10'X14'X2' Pond with Waterfall includes:

Pond and Waterfall Liners * Skimmer * Biological Filter * Energy Efficient Pump * Rock Boulders (Standard up to 150 lbs) (Premium Artisan up to 2000 lbs boulders) * River Stone * Design and Installation

This size pond on display at our retail store

ENHANCEMENTS Available WITH YOUR POND WITH WATERFALL:

Lights - Envision sitting outside during the morning or evening hours enjoying your water feature. LED water feature lights will extend the viewing times for your feature.

Pond with Waterfall Light Kit includes:

- 3 LED color changing lights
- Low voltage transformer
- Low voltage cable

Upgrade to a 10' ft long stream.

Bog Skimmer - less maintenance than a traditional skimmer.

Faux Stump Cover - A great way to hide electrical outlets.

Auto-Fill System - Automatically detects low water levels and fills your feature with water.

Water plants - A selection of aquatic plants will provide color and texture to your water feature.

Koi Tunnel - The perfect place for your fish to hide if they feel threatened.

Bridge - Add interactive appeal with a bridge.

Echo Chamber - Intensify the sound.

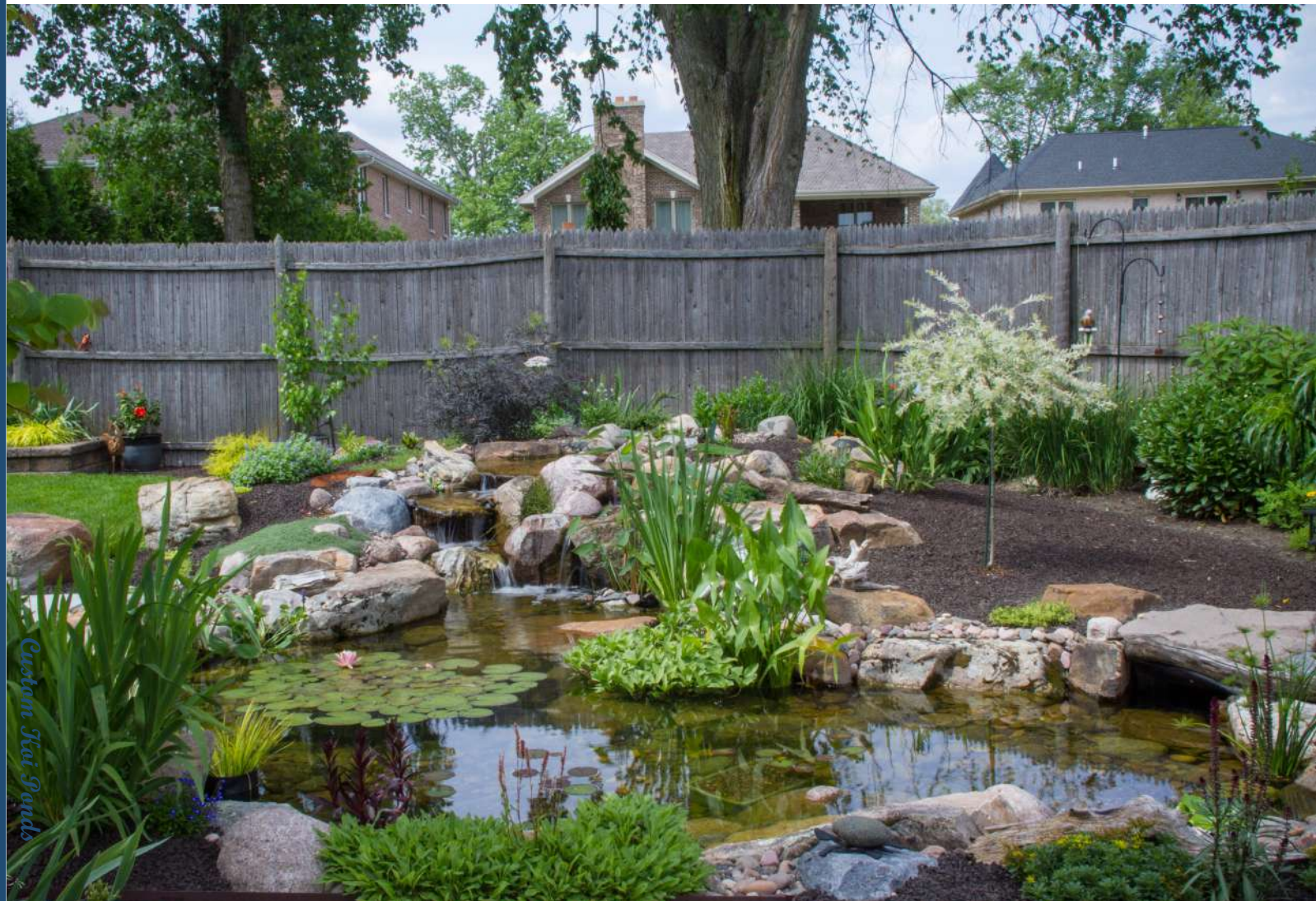

11'X16'X2' Custom Koi Pond

Do you dream about going home to your pond and waterfall to feed your beautiful fish right out of your hand? Then the 11' x 16' x 2' deep pond is perfect for you. The 11'X16'X2' pond comes with a cascading 2' high waterfall and 7' stream and is ideal for fish.

This size pond on display at our store

11'X16'X2' Pond with Waterfall includes:

Pond and Waterfall Liners • Skimmer • Biological Filter • Energy Efficient Pump • Rock Boulders (Standard up to 150 lbs boulders) (Premium Artisan up to 2000 lb boulders) • River Stone • Design and Installation

Upgrade to a 12' stream for a little more!

ENHANCEMENTS Available WITH YOUR POND WITH WATERFALL:

Lights - Envision sitting outside during the morning or evening hours enjoying your water feature. LED lights will extend the viewing times for your water feature.

Pond with Waterfall Light Kit includes:

- 3 LED color changing lights
- Low voltage transformer
- Low voltage cable

Upgrade to a 12' ft long stream.

Bog Skimmer - less maintenance than a traditional skimmer.

Faux Stump Cover - A great way to hide electrical outlets.

Auto-Fill System - Automatically detects low water levels and fills your feature with water.

Water plants - A selection of aquatic plants will provide color and texture to your water feature.

Koi Tunnel - The perfect place for your fish to hide if they feel threatened.

Bridge - Add interactive appeal with a bridge.

Echo Chamber - Intensify the sound of your waterfall.



16'X21'X3' Custom Koi Pond

Do you enjoy entertaining and believe a beautiful pond and waterfalls would be the perfect addition to your landscape? Amaze your guests with this impressive 16'x21'x3' deep pond complete with two 3' high waterfalls and two meandering 6' long streams.

Custom Koi Ponds

This size pond on display at our store

16'X21'X3' Pond with Waterfall includes:

Pond and Waterfall Liners • Skimmers • Biological Filters • Energy Efficient Pumps • Rock Boulders (Standard up to 150 lb boulders) (Premium Artisan up to 2000 lb boulders) • River Stone • Design and Installation

Upgrade one stream to 11' for a little more!

ENHANCEMENTS Available WITH YOUR POND WITH WATERFALLS:

Lights - Envision sitting outside during the morning or evening hours enjoying your water feature. LED water feature lights will extend the viewing times for your feature.

Pond with Waterfall Light Kit includes:

- 10 LED spotlights
- Low voltage transformer
- Low voltage cable

Upgrade one stream to 11' ft long.

Bog Skimmer - less maintenance than a traditional skimmer.

Faux Stump Cover - A great way to hide electrical outlets.

Auto-Fill System - Automatically detects low water levels and fills your feature with water.

Water plants - A selection of aquatic plants will provide color and texture to your water feature.

Koi Tunnel - The perfect place for your fish to hide if they feel threatened.

Bridge- Add interactive appeal with a bridge.

Echo Chamber- Intensify the sound of your waterfall.



20'X30'X3' Custom Koi Pond

Custom Koi Ponds

Do you enjoy entertaining and believe a beautiful pond and waterfalls would be the perfect addition to your landscape? Amaze your guests with this impressive 20'x30'x3' deep pond complete with two 3' high waterfalls. One in a meandering 10' long stream and one as a dramatic sheet style waterfall.

This size pond on display at our store

20'X30'X3' Pond with Waterfall includes:

Pond and Waterfall Liners • Skimmers • Biological Filters • Energy Efficient Pumps • Rock Boulders (Standard up to 150 lb boulders) (Premium Artisan up to 2000 lb boulders) • River Stone • Design and Installation

Upgrade one stream to 15' for a little more!

ENHANCEMENTS Available WITH YOUR POND WITH WATERFALLS:

Lights - Envision sitting outside during the morning or evening hours enjoying your water feature. LED water feature lights will extend the viewing times for your feature.

Pond with Waterfall Light Kit includes:

- 12 LED color changing lights
- 2 Low voltage transformers • Low voltage cable

Echo Chamber - Intensify the sound of your waterfall.

Upgrade one stream to 15' ft long.

Bog Skimmer - Less maintenance than a traditional skimmer.

Faux Stump Cover - A great way to hide electrical outlets.

Auto-Fill System - Automatically detects low water levels and fills your feature with water.

Water plants - A selection of aquatic plants will provide color and texture to your water feature.

Koi Tunnel - The perfect place for your fish to hide if they feel threatened.

Bridge - Add interactive appeal with a bridge.

Night lighting adds a whole new element to your pond when the sun goes down.



*Dare to
Dream*



Garden Ponds Unlimited



*Do you have something larger in mind?
Our ponds are completely
customizable. The sky's the limit!*



*Featured on this page are
all 1/2 acre ponds*



*Koi ponds bring joy and relaxation
all year long.*

*Let us create your Winterland
Wonderland. ❄️*

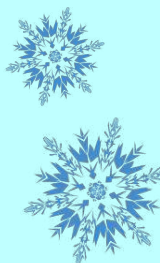

Large & Mid-scale Commercial Projects



Endangered Turtle Pond Habitat at the OKC Zoo. Look for this at the reptile building.

One of our favorite neighborhood entrance projects.

Large waterfall & pond in front and meandering stream on the back side.

Tuttle, OK



Large & Mid-scale Commercial Projects



Upscale RV park entrance includes a large pond with four streams & waterfalls. Plus six small pondless waterfalls throughout the park.

Western Oklahoma



Oklahoma State Fairgrounds



*Neighborhood
Entrance
Norman, OK*



*Stovall
Museum
Norman, OK*



What's the Difference Between Our Premium Artisan Ponds and Pondless Waterfalls Vs. Our Standard Ponds and Waterfalls?



Premium Artisan Ponds & Pondless Waterfalls have more “wow factor” than our standard installations. These premium projects feature boulders that are up to 2000 lbs and require backyard access for machinery as they include much larger boulders that have to be set with excavators. These premium projects require more time to build, include larger pumps and of course, more sound.



Artisan Packages Make a Bigger Splash!



Larger Boulders up to 2000 lbs.

*Add Some "WOW FACTOR"
to your yard.*

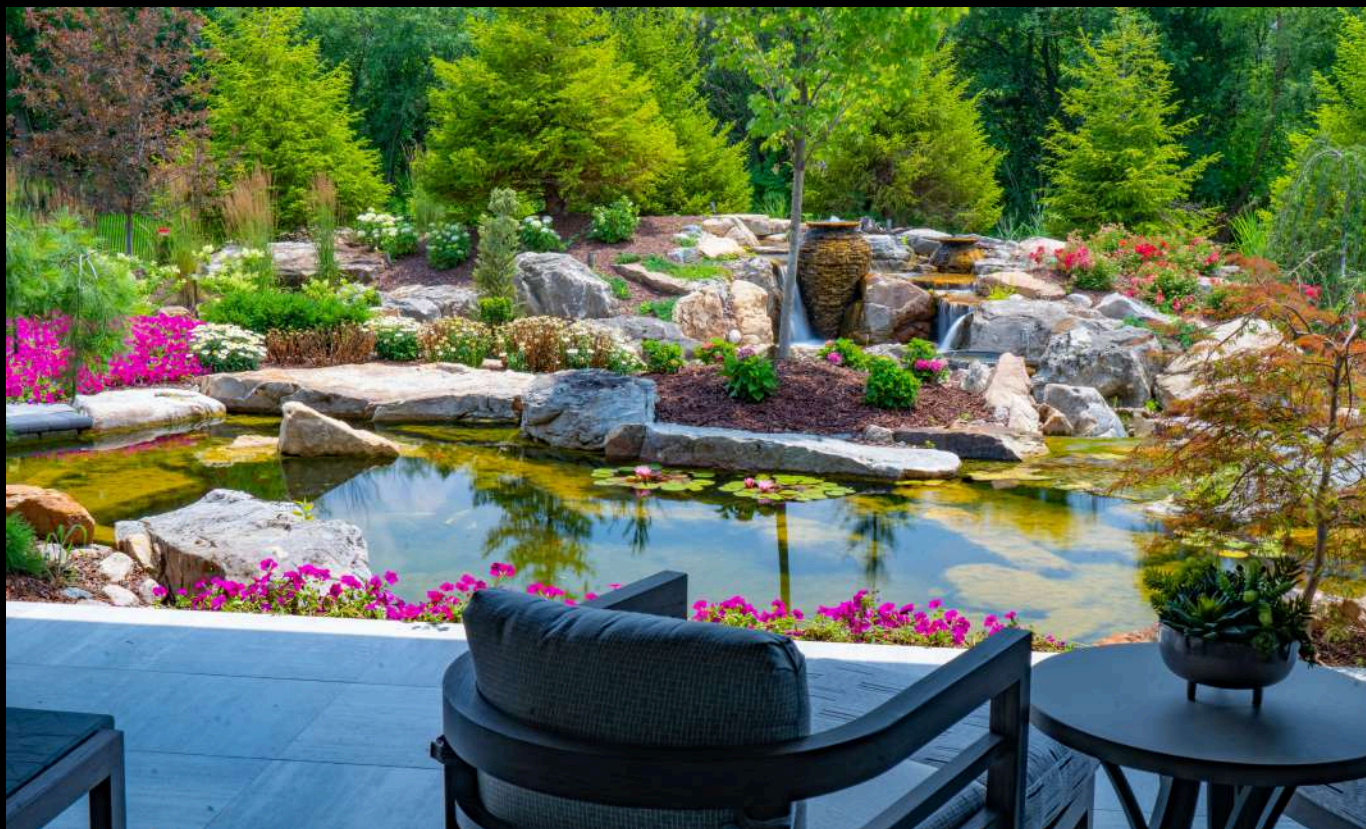

Service After The Sale!

Once we build your pond, rest assured that is not the end of our relationship. With over 28 years in business, service after the sale is one of our top priorities.



We have dedicated teams for.....

- Pond & Water Feature Cleanings
- Emergency Repairs
- Weekly Maintenance
- Monthly Maintenance
- Vacation Maintenance Service



Koi ponds should be cleaned twice a year

*Large enough to handle of all your
pond & water feature needs.
Small enough to care!*





Did you know that we are an award winning company? Yep, nationally ranked.

Our Store

I have a water feature...

Are you disappointed that your current “pond specialist” can’t seem to provide you with answers to your questions? Are you upset that what they’re recommending is not providing the desired results? Are you frustrated that they don’t seem to carry the essential products necessary to enhance your feature?

We've got you covered. Bring in a picture so together, we can explore the many ways to enhance your water feature, giving it new life. There is a lot of science that goes into constructing a properly functioning Koi pond. Our staff has been trained extensively and can help guide you in the right direction.

I want to build a water feature...

Are you considering building your own water feature? Visit our Store for design ideas and start dreaming up your own water feature project. We carry a wide range of DIY kits.

What products do we carry?

In our fully stocked store you’ll find a huge selection of DIY pond kits, pumps, filters, lights, water treatments, fish and plants. We invite you to visit our store and see all the possibilities that exist for your water feature!

Come visit our friendly knowledgeable staff

Monday -Saturday 10am to 5pm



Come visit our pond store. It's a fun place.



We sell over 100 different varieties of Koi and fish.



We stock over 75 different varieties of pond plants. We carry turtles too.



Recreational Ponds



Our large ponds can be built as "Recreational Ponds" that the whole family will enjoy. Sit on the edge with your feet dangling in the water or jump in and swim with the Koi.

These fully filtered, natural ponds bring mother nature and people together.

Recreational ponds do not use irritating chemicals like chlorine. Fish can live in our recreational ponds, doubling the homeowners enjoyment over a pool.



Have a swimming pool without waterfalls?

We can enhance your existing pool by adding beautiful waterfalls. We can built it into your existing system or on the edge so that it is independent of the pool but appears to be all one unit.



Puppy Splash Pads



Ponds provide our fur babies with filtered drinking water and a splash pad in the hot weather.

Garden Ponds Unlimited 2025 Pricing

OKC Metro Area Price List

Ask us about our statewide installation prices

Custom Ponds *(These sizes can be customized to meet your specific needs.)*

4'X6'X2'	Standard Pond	\$ 6000	Boulders up to 150 lbs
6'X8'X2'	Standard Pond	\$ 7000	Boulders up to 150 lbs
8'X10'X2'	Standard Pond	\$ 9000*	Boulders up to 150 lbs
10'X14'X2	Standard Pond	\$10500	Boulders up to 150 lbs
10'X14'X2'	Premium Artisan Pond	\$15500*	Boulders up to 2000 lbs
11'X16'X2'	Standard Pond	\$12500	Boulders up to 150 lbs
11'X16'X2'	Premium Artisan Pond	\$19500	Boulders up to 2000 lbs
16'X21'X3'	Standard Pond	\$24000* (two streams)	Boulders up to 150 lbs
16'X21'X3'	Premium Artisan Pond	\$39000 (two streams)	Boulders up to 2000 lbs
20'X30'X3'	Standard Pond	\$33500* (two streams)	Boulders up to 150 lbs
20'X30'X3'	Premium Artisan Pond	\$53500 (two streams)	Boulders up to 2000 lbs
Larger or Recreation Ponds starting at \$60,000 +			

Pondless Waterfalls *(These sizes can be customized to meet your specific needs.)*

6' Stream X 1' Standard Small Pondless Waterfall	\$6000 small spillway/ boulders up to 150lbs
6' Stream X 1' Standard Medium Pondless Waterfall	\$8000 medium spillway/ boulders up to 150 lbs
6' Stream X 2' Premium Artisan Pondless Waterfall *	\$12000 medium spillway /boulders up to 2000 lbs
10' Stream X 2' Standard Pondless Waterfall	\$13000 boulders up to 150 lbs
10' Stream X 4' Standard Pondless Waterfall*	\$18000 boulders up to 150 lbs
10' Stream X 2' Premium Artisan Pondless Waterfall	\$18000 boulders up to 2000 lbs
15' Stream X 2.5' Standard Pondless Waterfall	\$18000 boulders up to 150 lbs
15' Stream X 2.5' Premium Artisan Pondless Waterfall	\$24000 boulders up to 2000 lbs
20' Stream X 3' Standard Pondless Waterfall	\$21500 boulders up to 150 lbs
20' Stream X 3' Premium Artisan Pondless Waterfall	\$34000 boulders up to 2000

Water Features

Medium Bubbler Rock	\$6000
Large Bubbler Rock	\$9000*
Medium Stacked Urn	\$6000
Medium Stacked Sphere	\$6000
Large Stacked Sphere	\$7500
Stacked Slate Wall	\$6000

Don't see a size that works for you? Don't worry, custom sizes are available! Larger ponds and multiple streams are available. Want larger boulders, we can do that too. The sky's the limit!

*This mark indicates sizes on display at our store.

Standard Ponds & Pondless Features come with rocks and boulders of various sizes up to 150 lbs per boulder/rock. Premium Artisan Ponds & Pondless' come with rocks and boulders of various sizes up to 2000 lbs per boulder/rock.

Prices subject to change without notice

Metro wide onsite consultation fee is applied towards the price of the job upon signing contract.

Enhancements & Add On's

- Color changing LED underwater lighting (3 light package) \$500
- Additional Lights \$150 each
- Sound intensifying Echo Chamber starting @ \$200
- Koi Tunnel starting @ \$250
- Koi Cave starting @ \$150
- Berm retention wall starting @ \$500
- Driftwood package starting @ \$250 (when in stock)
- Accent tree trunk/log (priced as available)
- Moss package starting @ \$250
- Rock stepping stones starting @ \$500 per stone
- Rock bridge starting @ \$500 (when in stock)
- Land bridge starting @ \$1500
- Flat wood bridge \$500 - \$1500
- Destination / viewing boulder \$500
- Out cropping boulder \$250 (up to 400 lbs)
- Jets (3 jet minimum) \$2250
- Pet ramp/beach \$250
- Gravity fed waterfall starting @ \$500



- Viewing wall (3' ft tall max) flat wall \$80 per sq face foot. Custom walls also available. Curved, bend and 3' ft +
- Negative /Infinity Edge (waterfalls into vanishing intake bay) starting at \$6000
- Fire Pit \$5000. If purchased with Premium Artisan feature, only \$2000
- Substitute pond skimmer(s) for bog intake bay(s) \$2000 extra per bog
- Heavy debris bog intake bay w/ skimmer starting @ \$3000

Hardy Aquatic Plant Package:	Small	\$200	(1 lily & 3 marginal)
	Medium	\$375	(2 lilies & 6 marginals)
	Large	\$425	(3 lilies & 6 marginals)

Rainwater Harvesting System Bid \$500

Landscaping Bid & Rendering \$500



Garden Ponds Unlimited LLC®

310 SW 1st ST

Moore, OK 73160



I-35 & 4th St on the North Service Road

405-799-POND (7663)

Open Monday - Saturday 10am - 5pm

www.gardenpondsunlimited.com

Connect with us



All prices are for the OKC metro area. Price will be adjusted accordingly for installations outside of the OKC metro. Price is dependent on backyard access and HOA rules regarding workability. Price could also fluctuate depending on rock size and soil type. Normal subsurface soil conditions are assumed. Conditions beyond our control such as buried rocks, stumps or any other unknown underground conditions will require additional charges. Garden Ponds Unlimited® reserves the right to change prices listed herein at anytime based on outside factors such as gas prices, product availability and manufacturer's price increases. Some pictures may show additional items not included in the listed price. Other conditions may apply.